

5. MAINTENANCE CHART

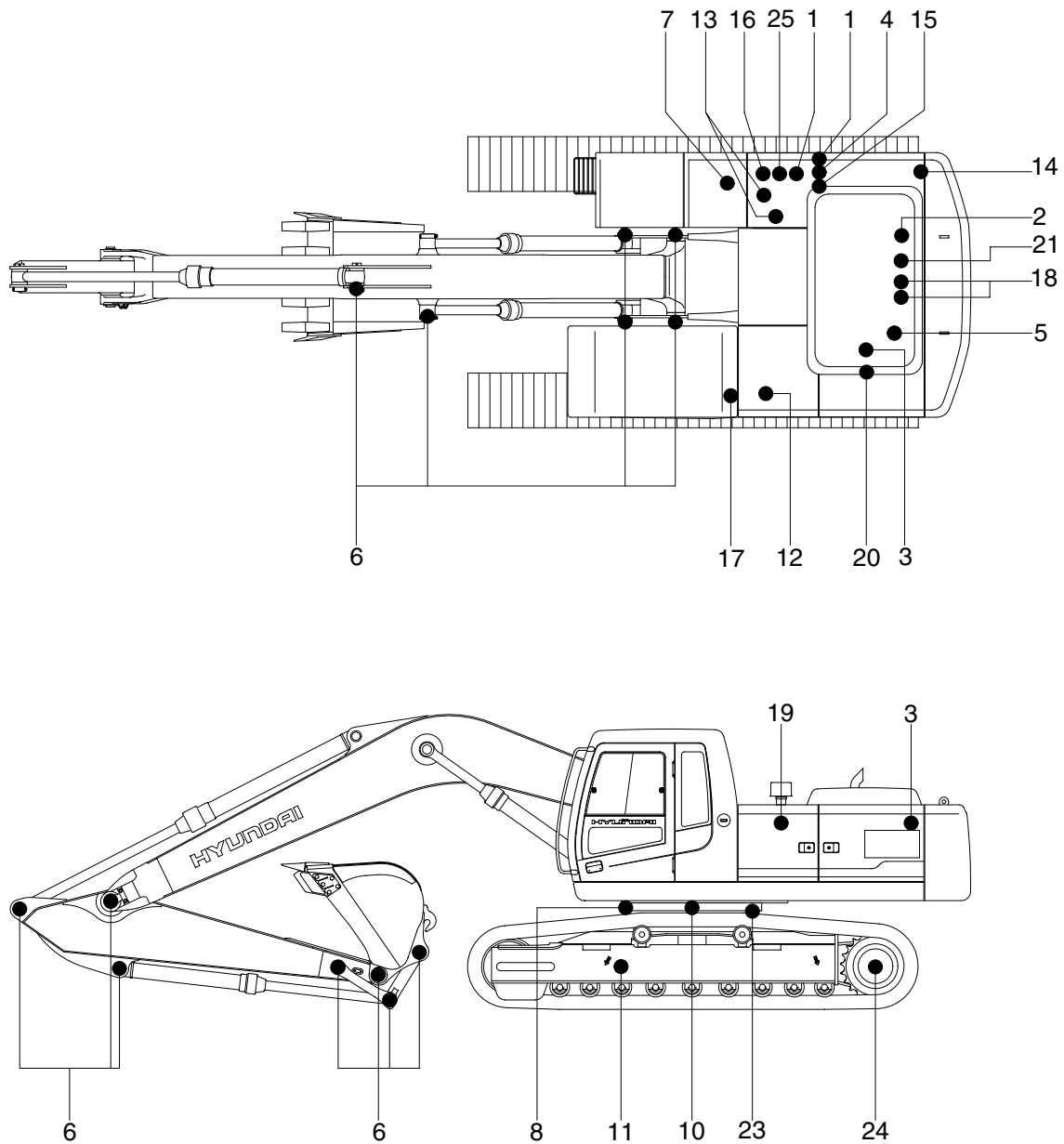

2907H6MI05

Caution

1. Service intervals are based on the hour meter reading.
2. The number of each item shows the lubrication point on the machine.
3. Stop engine while filling oil, and use no open flames.
4. For other details, refer to the service manual.

Service interval	No.	Description	Service action	Oil symbol	Capacity l (U.S.gal)	Service points No.
10 Hours or daily	1	Hydraulic oil level	Check, Add	HO	190(50.2)	1
	2	Engine oil level	Check, Add	EO	27.3(7.21)	1
	3	Radiator coolant	Check, Add	C	50(13.2)	1
	4	Water separator	Check, Drain	-	-	2
	5	Fan belt tension & damage	Check	-	-	1
50 Hours or weekly	6	Attachment pins	Check, Add	PGL	-	17
	7	Fuel tank(Water, sediment)	Check, Clean	-	-	1
	8	Swing bearing grease	Check, Add	PGL	-	3
	9	Swing drive gear case	Check, Add	GO	7.0(1.8)	1
	11	Track tension	Check, Adjust	PGL	-	2
250 Hours	2	Engine oil level	Change	EO	27.3(7.2)	1
	12	Battery(Electrolyte, voltage)	Check, Add	-	-	2
	13	Hydraulic oil return filter	Replace	-	-	1
	14	Line filter element	Replace	-	-	1
	15	Drain filter cartridge	Replace	-	-	2
	16	Air breather element	Replace	-	-	1
	17	Aircon & heater fresh air filter	Check, clean	-	-	1
	18	Engine oil filter	Replace	-	-	1
500 Hours	19	Air cleaner element(Primary)	Clean	-	-	2
	20	Radiator and oil cooler	Check, Clean	-	-	1
	21	Fuel filter element	Replace	-	-	2
1000 Hours	9	Swing drive gear case	Change	GO	7.0(1.8)	1
	23	Swing gear and pinion	Change	PGL	11.6(3.1)	1
	24	Final drive gear case	Change	GO	5.5(1.5)	2
2000 Hours	1	Hydraulic oil level	Change	HO	190(50.2)	1
	3	Radiator coolant	Change	C	50(13.2)	1
	25	Hydraulic oil suction strainer	Check, Clean	-	-	1
As required	17	Aircon & heater fresh air filter	Replace	-	-	1
	17	Aircon & heater recirculation filter	Clean, replace	-	-	1
	19	Air cleaner element(Primary, safety)	Check, replace	-	-	2

※ **Oil symbol**

Please refer to the recommended lubricants for specification.

DF : Diesel fuel GO : Gear oil
HO : Hydraulic oil C : Coolant
PGL : Grease EO : Engine oil