

2. SPECIFICATIONS

1) R290LC-7

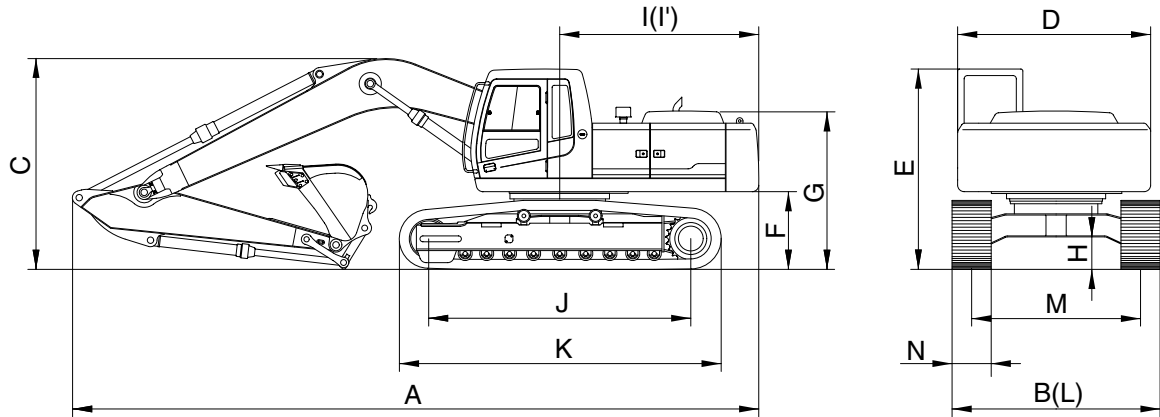

29072SP01

Description		Unit	Specification
Operating weight		kg(lb)	29300(64600)
Bucket capacity(PCSA heaped), standard		m ³ (yd ³)	1.27(1.66)
Overall length	A	mm(ft-in)	10560(34' 8")
Overall width, with 600mm shoe	B		3200(10' 6")
Overall height	C		3290(10' 10")
Superstructure width	D		2980(9' 9")
Overall height of cab	E		3010(9' 11")
Ground clearance of counterweight	F		1190(3' 11")
Engine cover height	G		3190(10' 6")
Minimum ground clearance	H		500(1' 8")
Rear-end distance	I		3200(10' 6")
Rear-end swing radius	I'		3120(10' 3")
Distance between tumblers	J		4030(13' 3")
Undercarriage length	K		4940(16' 2")
Undercarriage width	L		3200(10' 6")
Track gauge	M		2600(8' 6")
Track shoe width, standard	N		600(24")
Travel speed(Low/high)		km/hr(mph)	3.1/5.2(1.9/3.2)
Swing speed		rpm	11
Gradeability		Degree(%)	35(70)
Ground pressure(600mm shoe)		kgf/cm ² (psi)	0.56(7.97)

2) R290NLC-7

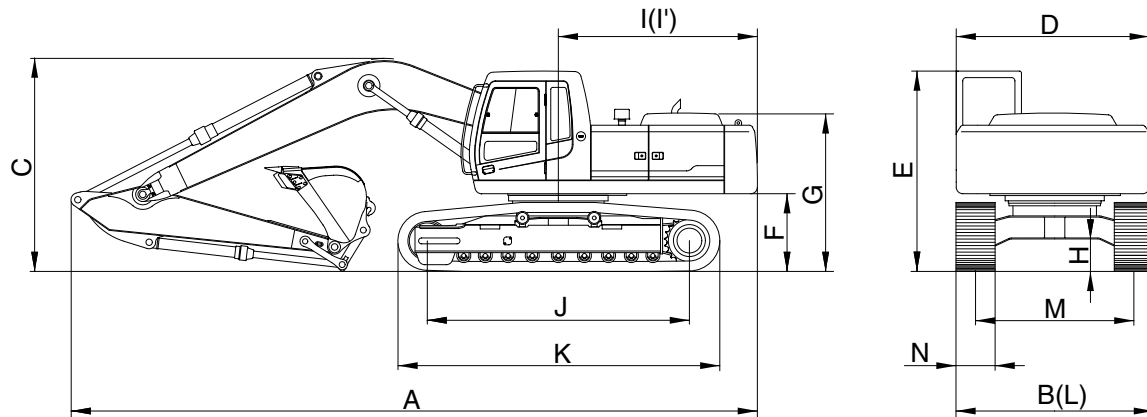

29072SP02

Description		Unit	Specification
Operating weight		kg(lb)	29100(64150)
Bucket capacity(PCSA heaped), standard		m ³ (yd ³)	1.27(1.66)
Overall length	A	mm(ft-in)	10560(34' 8")
Overall width, with 600mm shoe	B		2990(9' 10")
Overall height	C		3290(10' 10")
Superstructure width	D		2980(9' 9")
Overall height of cab	E		3010(9' 11")
Ground clearance of counterweight	F		1190(3' 11")
Engine cover height	G		3190(10' 6")
Minimum ground clearance	H		500(1' 8")
Rear-end distance	I		3200(10' 6")
Rear-end swing radius	I'		3120(10' 3")
Distance between tumblers	J		4030(13' 3")
Undercarriage length	K		4940(16' 2")
Undercarriage width	L		2990(9' 10")
Track gauge	M		2390(7' 10")
Track shoe width, standard	N		600(24")
Travel speed(Low/high)		km/hr(mph)	3.1/5.2(1.9/3.2)
Swing speed		rpm	11
Gradeability		Degree(%)	35(70)
Ground pressure(600mm shoe)		kgf/cm ² (psi)	0.55(7.82)

3) R290LC-7 LONG REACH

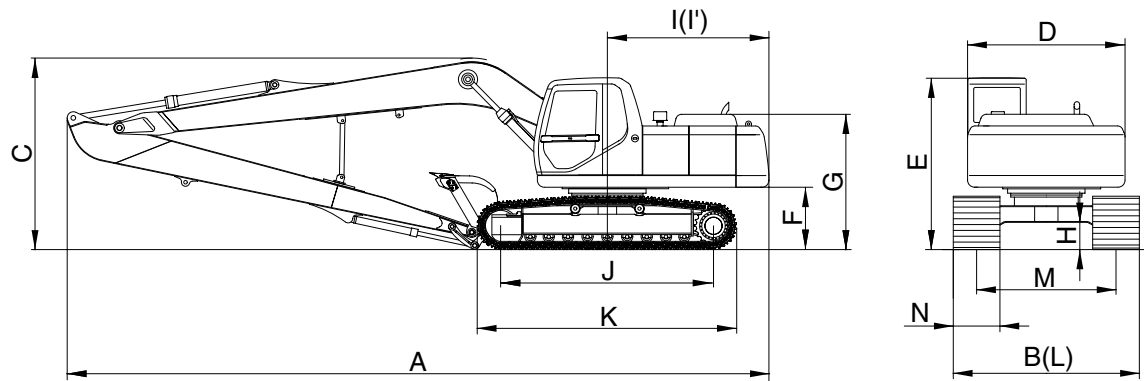

29072SP06

Description		Unit	Specification
Operating weight		kg(lb)	32690(72630)
Bucket capacity(PCSA heaped), standard		m³(yd³)	0.52(0.68)
Overall length	A	mm(ft-in)	14550(47' 9")
Overall width, with 800mm shoe	B		3400(11' 2")
Overall height	C		3550(11' 8")
Superstructure width	D		2980(9' 9")
Overall height of cab	E		3010(9' 11")
Ground clearance of counterweight	F		1190(3' 11")
Engine cover height	G		3190(10' 6")
Minimum ground clearance	H		500(1' 8")
Rear-end distance	I		3200(10' 6")
Rear-end swing radius	I'		3120(10' 3")
Distance between tumblers	J		4030(13' 3")
Undercarriage length	K		4940(16' 2")
Undercarriage width	L		3400(11' 2")
Track gauge	M		2600(8' 6")
Track shoe width, standard	N		800(31' 5")
Travel speed(Low/high)		km/hr(mph)	3.1/5.2(1.9/3.2)
Swing speed		rpm	11
Gradeability		Degree(%)	35(70)
Ground pressure(800mm shoe)		kgf/cm²(psi)	0.44(6.26)

4) R290LC-7 HIGH WALKER

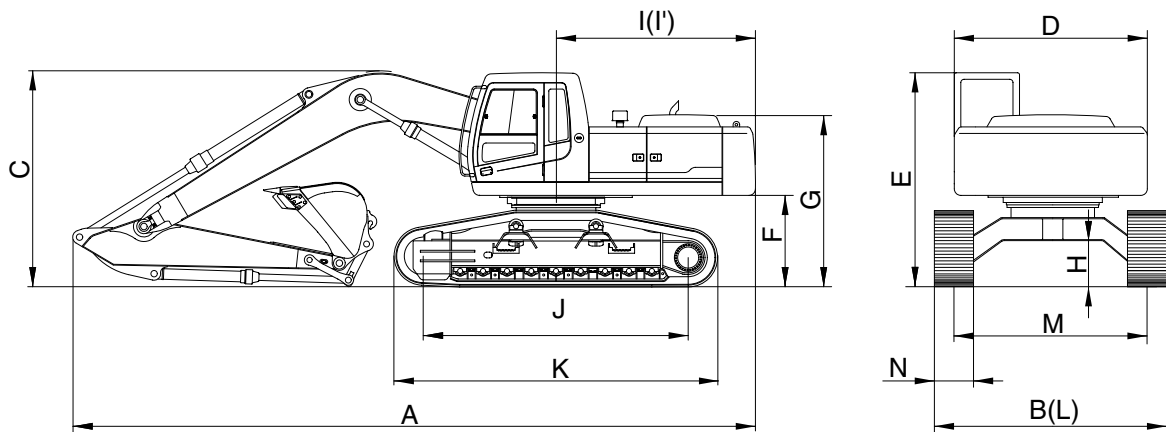

29072SP07

Description		Unit	Specification
Operating weight		kg(lb)	32140(70860)
Bucket capacity(PCSA heaped), standard		m³(yd³)	1.27(1.66)
Overall length	A	mm(ft-in)	10430(34' 3")
Overall width, with 600mm shoe	B		3470(11' 5")
Overall height	C		3350(11' 0")
Superstructure width	D		2980(9' 9")
Overall height of cab	E		3380(11' 1")
Ground clearance of counterweight	F		1500(4' 11")
Engine cover height	G		3500(11' 6")
Minimum ground clearance	H		765(2' 6")
Rear-end distance	I		3200(10' 6")
Rear-end swing radius	I'		3120(10' 3")
Distance between tumblers	J		4030(13' 3")
Undercarriage length	K		4950(16' 3")
Undercarriage width	L		3470(11' 5")
Track gauge	M		2870(9' 5")
Track shoe width, standard	N		600(23' 6")
Travel speed(Low/high)		km/hr(mph)	3.1/5.2(1.9/3.2)
Swing speed		rpm	11
Gradeability		Degree(%)	35(70)
Ground pressure(600mm shoe)		kgf/cm²(psi)	0.62(8.82)